



THE SAFEWAY COMPANIES

Safeway • Vons • Pavilions • Dominick's • Carrs
Tom Thumb • Randaills • Genuardi's • Pak'n Save



Bluemont Civic Association
Atten: Judah dal Cais, President
P.O. Box 5134
Arlington, Va. 22205

RE: Safeway Store # 1358
5101 Wilson Blvd.,
Arlington, Virginia 22205

Dear Mr. Judah dal Cais,

I am in receipt of your letter regarding the use of our parking area for D&V Budget Trucks which is I believe is located next door to our Safeway store at the above mentioned address.

Safeway will be more than happy to work with you and Mr. Guenther in regards to the continued use of our parking area.

There are certain stipulations that in the past had been discussed but I believe not followed through on.

- 1) Any permitting fees will be covered by D&V or The Bluemont Civic Association.
- 2) After an agreement is reached, Safeway will provide our standard License agreement to be signed by D&V for the use of our parking area.
This will include a monthly fee which we can negotiate at a later date.
- 3) D&V must carry 2,000,000. Liability insurance listing Safeway Inc., as additionally insured for liability on any and each occurrence and to indemnify Safeway and hold them harmless from any and all issues that may arise.
- 4) Attached you will find a Site plan which will upon signing show specifically where the trucks will be allowed to park. This must be respected or the additional trucks will be towed and or any fines that are directed to Safeway will be forwarded to D&V and The Bluemont Civic Association.

I will be happy to meet with you to discuss any questions you or Mr. Guenther may have.

4551 Forbes Boulevard
Lanham, MD 20706
Tel 301/918-6791
Fax 301/918-6831

I look forward to hearing from you.

Sincerely,
SAFEWAY INC.



Lisa S. Levine
Senior Regional Property Manager
Safeway Inc.

Attachments: Site Plan

Cc: File
Avis Black
Marilyn Beardsley, Esq.

4551 Forbes Boulevard
Lanham, MD 20706
Tel 301/918-6791
Fax 301/918-6831

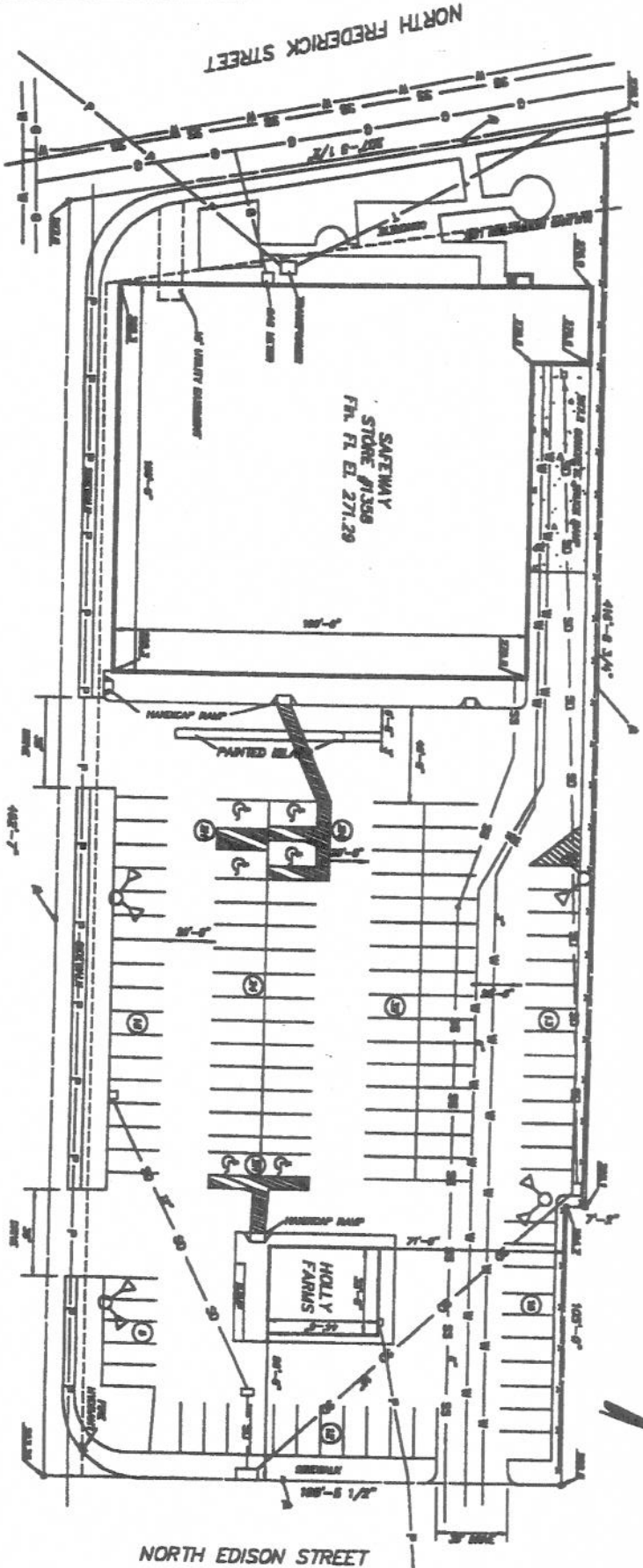

PRIORITY	Sq. Ft. Area	SEWERAGE	Sq. Ft. Area	TYPE OF LOCATION
SAFETY - 4th FLOOR	84,200	COLLECTOR	12,412	ADJACENT TO S.A. D.
GENERAL - 1st FLOOR	5,450	SEWER MAIN	2,200	TYPE OF SEWER IN
PROPOSED	77,000	SEWERAGE		EXISTING SPACES
GREEN LAND				ADJACENT TO SEWERAGE, THE
				ADJACENT TO SEWERAGE, -
				TOTAL IN SEWER, SEWERAGE -

LEGEND

- 2'-400V HIGH PRESSURE SEWER LINES
- THE HYDRANT
- ACCESSIBLE PARKING SPACES
- NUMBER OF PARKING SPACES

- SD STORAGE DRAIN
- GL GAS LINE
- SS SANITARY SEWER
- W WATER LINE
- P POWER LINE
- T PHONE LINE
- F FENCE
- A PROPERTY LINE
- EL ELEVATION

HISTORY RECORD

PLOT PLAN
 STORE NO. 1358
 5101 WILSON BOULEVARD
 ARLINGTON, VIRGINIA

STORE NO.	ZONE NO.	DATE	DRG. NO.
1358	2B		P-1

ONE HUNDRED FIFTY-ONE
 WILSON BOULEVARD, ARLINGTON, VIRGINIA
 SOON OVER ASSOCIATED, INC.
 ENGINEER / ARCHITECT / PLANNER
 WASHINGTON, D.C. 20004